

ELPA

LED Multi-Purpose Light

Slim & Flat
LED
LIGHT - For Indoor Use -

Easy to Install !!

For: Kitchen, Storage, Store Display Shelves, etc.

Easily Set up Lighting Anywhere

No-touch Switch

Easily turn ON/OFF by swiftly waving hand by the switch

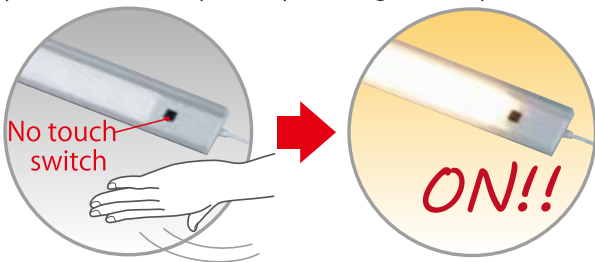

Easy Set Up

- Magnet Attachment
- Double-sided Tape
- Wooden Screws (attachment)

Slim & Bright

Slim body, but bright even light

Energy Saving

Low energy, long lasting

● Choose from 2 light colors

Daylight

Warm White

● Choose from 3 sizes

30cm

60cm

90cm

Use in Various Places!

Magnet attachment bracket, wooden screws, and double-sided tape included!



Kitchen



Storage



Shelves

For work light, interior light!

Slim&Flat

LED

LIGHT Multi-Purpose Light

For Indoor Use

Slim design, no-touch switch

Choose from 3 sizes, 2 lighting colors

30cm Type

Daylight

ALT-1030IR(D)

Warm White

ALT-1030IR(L)



60cm Type

Daylight

ALT-1060IR(D)

Warm White

ALT-1060IR(L)



90cm Type

Daylight

ALT-1090IR(D)

Warm White

ALT-1090IR(L)



Power Consump.	5.0 W		
AC Adapter	Input: AC100-240V 50/60Hz 0.5A Output: DC24V 0.62A Cord Length: 1.8m		
Light Source	LED (Daylight)	LED (Warm white)	
	Lumens	260 lm	260 lm
Lux (Height: 1m)	Daylight	90 lux	Warm white
			80 lux
Ra	80		
Usage Temp.	5~35°C		
Outer Dimension	H300 x W30 x D8(mm)		
Weight	Approx. 65g		
Cord Length	0.5m		
Accessories	<ul style="list-style-type: none"> ●AC Adapter ●Magnet Attacher x 2pcs ●Wooden Screws (S: 2pcs, L: 2pcs) ●Double-side tape x2pcs ●Sleeve x2pcs 		

Power Consump.	9.0 W		
AC Adapter	Input: AC100-240V 50/60Hz 0.5A Output: DC24V 0.62A Cord Length: 1.8m		
Light Source	LED (Daylight)	LED (Warm white)	
	Lumens	550 lm	510 lm
Lux (Height: 1m)	Daylight	185 lux	Warm white
			170 lux
Ra	80		
Usage Temp.	5~35°C		
Outer Dimension	H600 x W30 x D8(mm)		
Weight	Approx. 115g		
Cord Length	0.5m		
Accessories	<ul style="list-style-type: none"> ●AC Adapter ●Magnet Attacher x 2pcs. ●Wooden Screws (S: 2pcs, L: 2pcs) ●Double-side tape x2pcs ●Sleeve x2pcs 		

Power Consump.	14.0 W		
AC Adapter	Input: AC100-240V 50/60Hz 0.5A Output: DC24V 0.62A Cord Length: 1.8m		
Light Source	LED (Daylight)	LED (Warm white)	
	Lumens	920 lm	850 lm
Lux (Height: 1m)	Daylight	280 lux	Warm white
			260 lux
Ra	80		
Usage Temp.	5~35°C		
Outer Dimension	H900 x W30 x D8(mm)		
Weight	Approx. 165g		
Cord Length	0.5m		
Accessories	<ul style="list-style-type: none"> ●AC Adapter ●Magnet Attacher x 2pcs. ●Wooden Screws (S: 2pcs, L: 2pcs) ●Double-side tape x2pcs ●Sleeve x2pcs 		

Daylight ALT-1030IR(D)

1778-2



Daylight ALT-1060IR(D)

1778-4



Daylight ALT-1090IR(D)

1778-6



Warm White ALT-1030IR(L)

1778-3



Warm White ALT-1060IR(L)

1778-5



Warm White ALT-1090IR(L)

1778-7



ELPA Web



Facebook



Youtube



ELPA 朝日電器株式会社

HP: www.elpa.co.jp